

Rules for the installation of Wicanders Dekwall using contact adhesive WICANDERS W-240

Substrates

Substrate must be level, smooth, permanently dry, firm and free of cracks, dirt and adhesion-inhibiting substances.

Old chalk, adhesive and oil paint residues must be roughened with a steel brush in order to obtain an absorptive substrate. Oil residues must be removed completely. The surface of any type of suitable wood or cork substrate must be structurally sound and solid, securely fixed, clean and free of all oil, grease, wax, dirt, varnish, shellac, or any contaminant which might act as a bond breaker. Any unevenness must be levelled with an appropriate levelling compound. Gypsum plaster and gypsum carton tiles as well as other very absorptive substrates must be primed (WAKOL D 3074, diluted 1:2 with water). Observe the information about dilution and drying time of the primers.

Dekwall Laying

Packaged tiles, adhesive should be acclimatised at job site in dry, well-ventilated area for a minimum of 48 hours. Remove tiles from packages just before starting laying. During the installation, maintain temperature and relative humidity to level consistent with those conditions, which will prevail when building is occupied. This means maintaining temperature range of 18°C to 28°C (65 F to 82F) and relative humidity range of 35% to 65%. In order to reach this climate, use heating or air conditioning for appropriate length of time prior to beginning installation.

WICANDERS Deckwall is a natural product and some shade variation is an inherent and attractive characteristic. To achieve the most pleasing blend of shades, shuffle different packs before laying.

Tools required

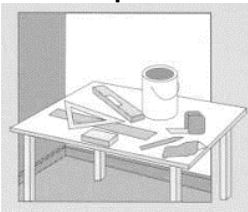

Rubber hammer, hand pressure roller, a tape measure, craft knife, pencil, straight edge, chalk line, mohair short hair roller, cloth.

Laying



Find the centre of the wall using a chalk line, draw two symmetrical axes and use these as a starting point.
Check if the intersection of the two lines forms a 90° angle.

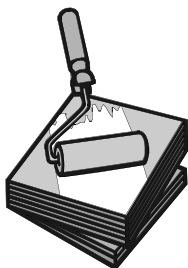

Stir the adhesive well, before using.

Apply the adhesive W 240 with mohair short hair roller to the backing of the cork tiles and on the wall.
Wait until the adhesive dries (about 45- 60 minutes). After the adhesive is dry and clear and you will see the lines again

Avoid pooling of adhesive. Coverage should be 150g/sqm on the tile and 150g/sqm on the wall.

Drying Time W-240: Let the adhesive dry completely (after it has dried the adhesive becomes transparent). Drying time is about 45-60 minutes, depending on the temperature and the relative humidity on site.

Open Time W-240:

Tiles: Pre-coated tiles may be stacked after drying and stored, protected from light, up to 1day.
Subfloor: Has an open assembly time of about 2-3 hours from the time on when the adhesive coat becomes transparent. If you are working with pre-coated tiles, the time will be reduced to 1 hour.

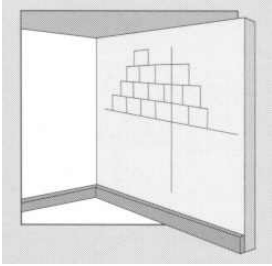

Install Dekwall tiles over to the wall covered with adhesive.

Dekwall should be installed as "Brick-Bond" layout: start the first row with full tile, the second row with half tile. For better visual effect, start installing from the middle.



Align one corner of the tile against the two axes and then carefully place down the rest of the tile.

Carefully align the next tile to the first and continue to stick the tiles to the wall.

Do not apply too much pressure when placing the tiles in order to be able to remove them if necessary, because after the tile sticks, it is very difficult to remove.

When the tile is in place, press with your hand to ensure that all parts are in contact with the wall adhesive. After use a rubber hammer to make sure all parts of the tile are well secured to the wall.



Continue the third and subsequent rows in the same manner, each alternating with the one before.

To insure proper bond, when whole area has been installed, press with rubber hammer. Press several times.

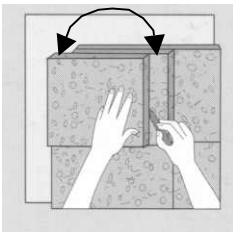

To cut the tiles to the required size, proceed as shown in Picture

Please be informed that W 240 needs more pressure on the walls than on the floor to get both adhesive films melted together to have a long lasting good bonding.