



Impact
Sound
Control

AcoustiCORK R60

For Hardwoods, Laminates
Ceramic Tile & Natural Stone



Highly Effective IIC Noise Reduction with Minimum Thickness
Versatile, Low Cost & Easy to Install with Long Term Durability
100% Natural & Sustainable Cork, Non-Toxic & Hypo-Allergenic



PRODUCT DESCRIPTION

Agglomerated 6mm Thick Cork Underlayment for Impact Noise
Attenuation of All Types of Hard Surface Flooring Materials



ENVIRONMENTAL PROPERTIES

Recycled Content (LEED MR-4)
85% + Recycled Content by Weight
Rapidly Renewing Content (LEED MR-6)
85% + Cork Granules by Weight



PHYSICAL AND MECHANICAL PROPERTIES (Per ASTM norms)

Density 11.5 to 13.6 lbs. ft.
Tensile Strength: > 200 KPa
Compression (100psi): < 30%
Recovery: > 90%
Durability: 10 Year Warranty
Robinson Testing Residential & Light Commercial Ratings



CERTIFIED BY
SCS Global Services



ACOUSTICAL RESULTS (ASTM E 90 & E 492)

13 Different Lab Tested Assemblies (Tested for STC & IIC Ratings) Wood Frame & Concrete Assemblies
Ceramic, Wood & Laminate Flooring
City of Los Angeles Research Report # RR25323A - IIC-ES Report # ESR 2768



PACKAGING

1m x 10m x 6mm Rolls



OTHER FEATURES & BENEFITS

Crack Suppression for Ceramic & Stone
Thermal Insulation -R-Value 3.12 per Inch
Naturally Resistant to Mold & Mildew
Reduces In Room Step Sound
Greater Comfort Under Foot
Class A Fire Rated in Assemblies
TCNA Method F-135 Approved



AMORIM
Amorim Cork Composites

AcoustiCORK®

SOUND CONTROL UNDERLAYMENTS

AcustiCORK R60 Sound Control Underlayment

Typical Installation Scenarios

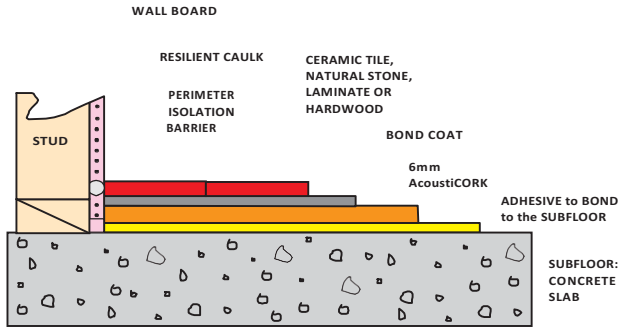

AcustiCORK on a CONCRETE SUBFLOOR

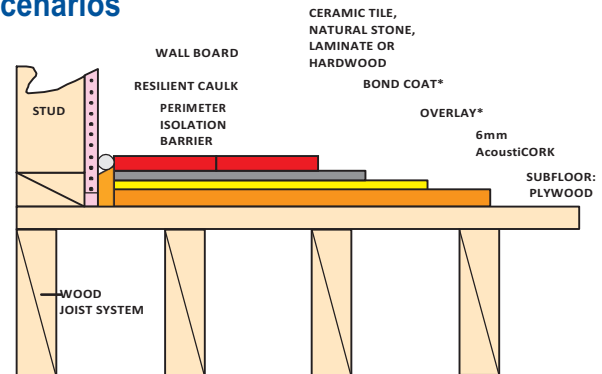

AcustiCORK on WOOD FRAME

(Note: If there is existing Gypsum or Lightweight concrete, install the AcustiCORK on top of it.)

*IF REQUIRED
1/2" CONCRETE BACKER UNIT
1 1/4" MORTAR SETTING BED
1" GYPSUM CONCRETE

General installation instructions

The following installation instructions are recommended by Amorim Cork Composites, but they are not intended as a definitive project specification. They are presented in an attempt to be used with recommended installation procedures of the flooring industry.

Job site conditions

Temperature > 55 °F / Room Relative Humidity < 75%.

Subfloor preparation

All subfloor work should be structurally sound, clean and level. The moisture content of the subfloor should be no more than 3 to 5 lbs. per 1000 s/f in 24 hours as per Calcium Chloride testing.

Perimeter isolation barrier

To maintain the acoustical integrity of the system, it is important that the finished flooring does not make direct contact with the perimeter walls, any fixed partitions or objects in the flooring area.

The use of a perimeter isolation strip is recommended.

For specification instructions, visit www.ecofloors.co.nz

Applying EcoFloors R60 to the subfloor

Cut the R60 material to the desired length and position it in the space to be covered. If the finished material is to be adhered, the underlayment must be glued down to the subfloor. If the final flooring is a "floating" floor, the underlayment does not have to be glued down. For glued down applications, p back about one half of the length of the cut material and using a properly sized notched trowel, apply one of the recommended adhesives to the subfloor. Place the R60 material into the layer of adhesive applied and press or embed it into the adhesive.

Repeat this process with the rest of the sheet. To ensure that the R60 underlayment is fully embedded in the adhesive and that there are no entrapped air pockets, roll it in both directions with a 75lb. or 100 lb. sectional floor roller. Proceed to cover the entire room area making sure that the underlayment sheets are tightly butted together, with no void or gaps.

Finished flooring materials

EcoFloors R60 underlayment can be used with almost any hard surface flooring material. There are multiple options for attachment of different flooring materials. See our website for specification details.

Sound Ratings for AcustiCORK® R60 Sound Control Underlayment Floor/Ceiling Assemblies

	Test Reference	Subfloor	AcustiCORK Product / Thickness	Suspended Ceiling	Overlay	Floor Covering	Sound Ratings IIC STC
WOOD JOIST FLOOR SYSTEMS (2x10 Sawn Joists 5/8 Wallboard -RC1)	RAL IN95-11•RAL TL95-118	5/8" Plywood	R60 - 6mm	Yes	1-1/2" Gypsum Concrete	Ceramic Tile	57 60
	RAL IN95-19•RAL TL95-126	5/8" Plywood	R60 - 6mm	Yes	1-1/2" Gypsum Concrete	Parquet Wood	54 59
	RAL IN95-15•RAL TL95-122	5/8" Plywood	R60 - 6mm	Yes	1-1/2" Gypsum Concrete	Laminate Floor	53 60
	RAL IN98-37•RAL TL98-186	5/8" Plywood	R60 - 6mm	Yes	1-1/2" Gypsum Concrete	Floating Wood	57 60
	RAL IN94-20•RAL TL94-296	5/8" Plywood	R60 - 6mm	Yes	1-1/2" Mortar Bed	Ceramic Tile	50 61
	RAL IN94-19•RAL TL94-274	5/8" Plywood	R60 - 6mm	Yes	1/2" Cement Backer Board	Ceramic Tile	50 64
CONCRETE FLOOR SYSTEMS	RAL IN95-3•RAL TL95-256	4" Slab	R60 - 6mm	Yes	1-1/2" Mortar Bed	Ceramic Tile	59 60
	RAL IN95-37•RAL TL95-256	6" Slab	R60 - 6mm	Yes	None	Ceramic Tile	61 60
	RAL IN95-43•RAL TL95-366	6" Slab	R60 - 6mm	Yes	None	Glued Wood	61 62
	RAL IN95-42•RAL TL95-365	6" Slab	R60 - 6mm	Yes	3/4" Plywood	Nailed Wood	61 61
	RAL IN95-41•RAL TL95-364	6" Slab	R60 - 6mm	Yes	None	Floating Wood	63 60
	RAL IN95-2•RAL TL95-40	6" Slab	R60 - 6mm	Yes	1/2" Cement Backer Board	Ceramic Tile	60 60
	RAL IN98-4•RAL TL98-27	6" Slab	R60 - 6mm	No	None	Floating Wood	50 52



AMORIM
Amorim Cork Composites

AcustiCORK PRODUCTS

Sound Control Underlayment & Crack Suppression Membrane
Amorim Cork Composites, Inc.
26112 110th Street • PO Box 25 • Trevor, WI 53179
(800)-558-3206 • (262)-862-2311 • FAX (262)-862-2500
www.acusticorkusa.com